

Features

- Usable bandwidth of 38 MHz
- Single-ended operation
- Ceramic Surface Mount Package
- This part number is a replacement for part number SMR-2324-45
- Hermetic

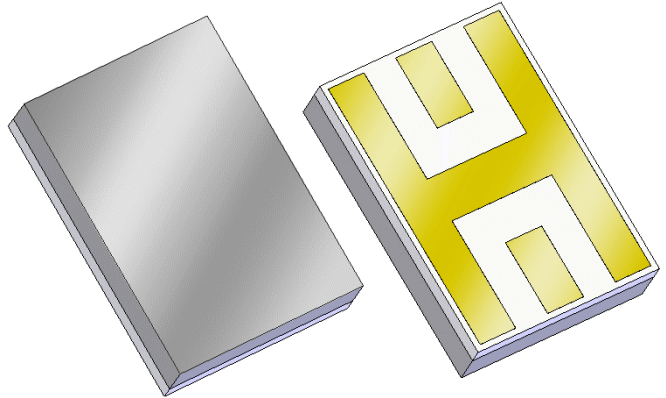

Package

Surface Mount 3.71 x 2.57 x 0.84 mm

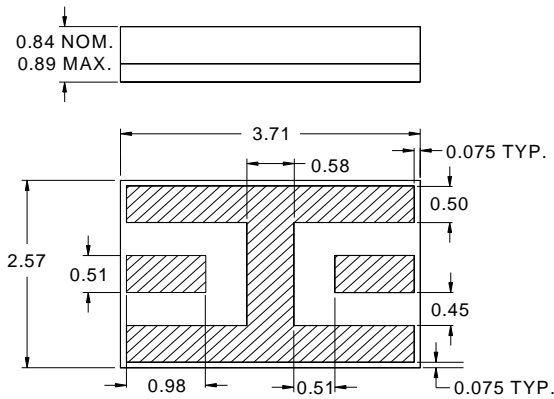

Pin Configuration

Bottom View

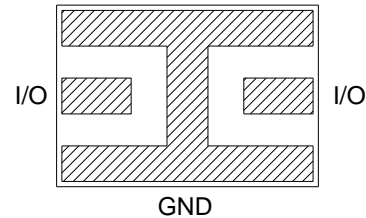

Pin No.	Description
I/O	Input/Output
GND	Ground

Overall width, length, and thickness are the only critical dimensions. All other dimensions are for reference only.

Dimensions shown are nominal in millimeters
All tolerances are $\pm 0.13\text{mm}$ except overall length and width $\pm 0.25\text{mm}$

Body: *Sapphire*
Package: *Alumina*
Terminations: *Au* plating 0.5 - 2.5 μm ,
over a 2.0 – 6.0 μm *Ni* plating

Electrical Specifications ⁽¹⁾

Operating Temperature Range: ⁽²⁾ -40 to +85 °C

Parameter ⁽³⁾	Minimum	Typical	Maximum	Unit
Center Frequency	-	2324	-	MHz
Insertion Loss at Fo	-	3	4.5	dB
3 dB Bandwidth ⁽⁴⁾	38	47	-	MHz
Lower 40 dB Bandedge	2249	-	-	MHz
Upper 40 dB Bandedge	-	-	2399	MHz
Input/Output VSWR @ Fo	-	-	2:1	-
Source Impedance	-	50	-	Ω
Load Impedance	-	50	-	Ω

Notes:

1. All specifications are based on the test circuit shown below
2. In production, devices will be tested at room temperature to a guardbanded specification to ensure electrical compliance over temperature
3. Electrical margin has been built into the design to account for the variations due to temperature drift and manufacturing tolerances
4. Referenced to the insertion loss at center frequency

Test Circuit:

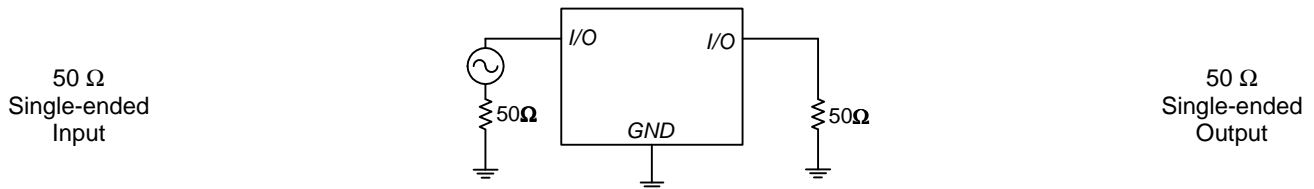

Typical Performance (at +25°C)

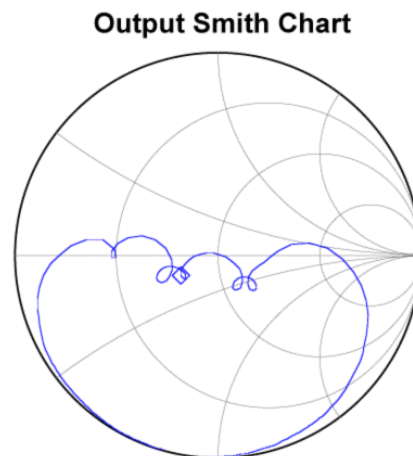
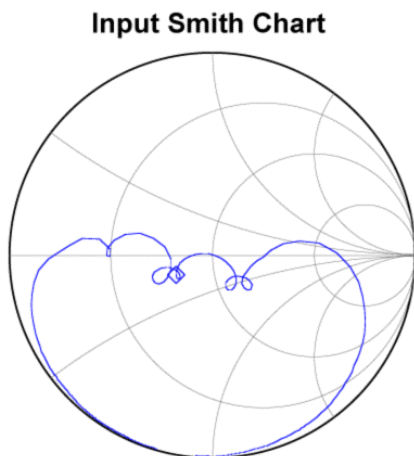
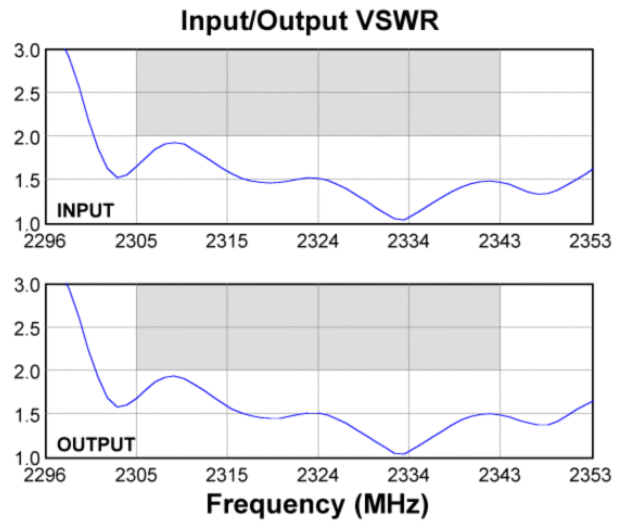
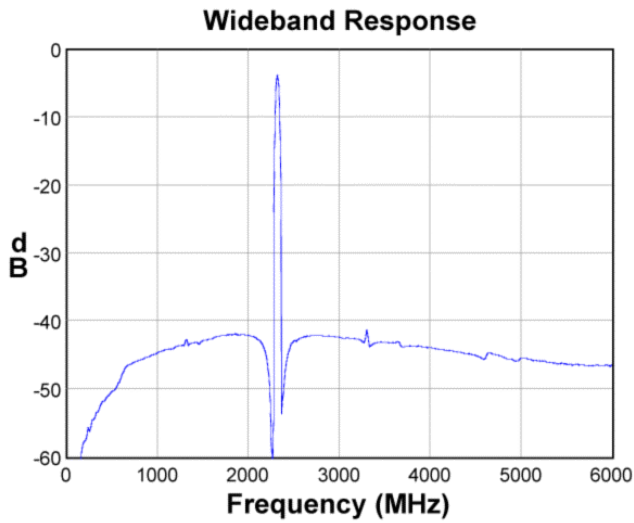
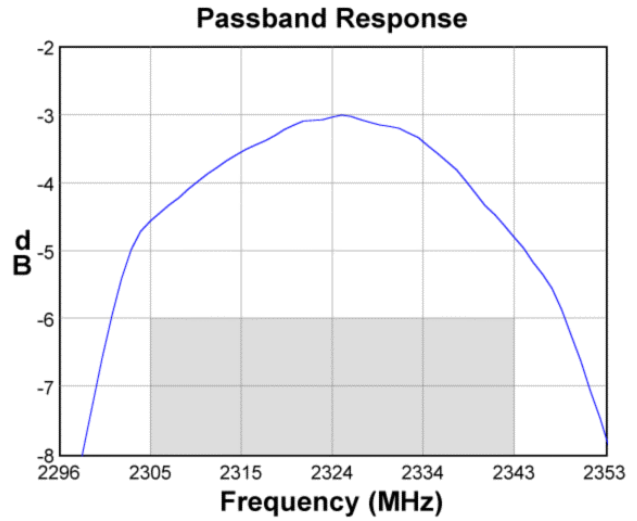
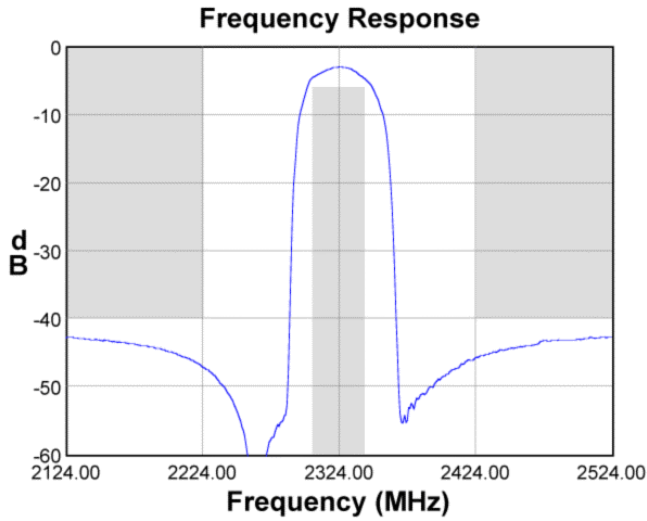

Matching Schematics

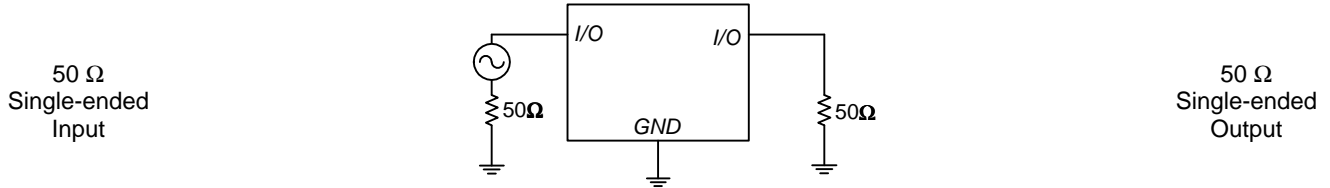

Marking

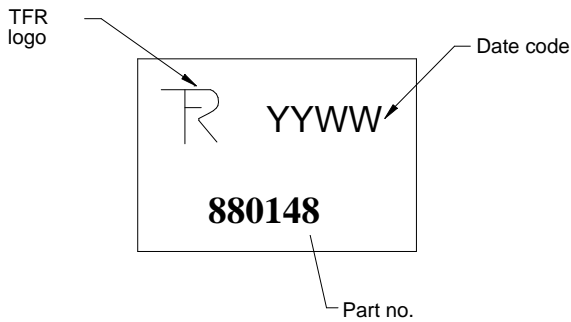

The date code consists of: YY = last digit of year,
WW = 2 digit week

PCB Footprint

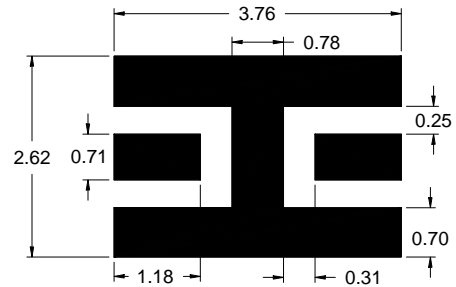

This footprint represents a recommendation only
Dimensions shown are nominal in millimeters

Tape and Reel

Tape and Reel available upon request
EIA-481

Tinning available per J-STD-001

ROHS compliant (no tinning)
DFARS compliant